

EXISTING SITE LOCATION PLAN

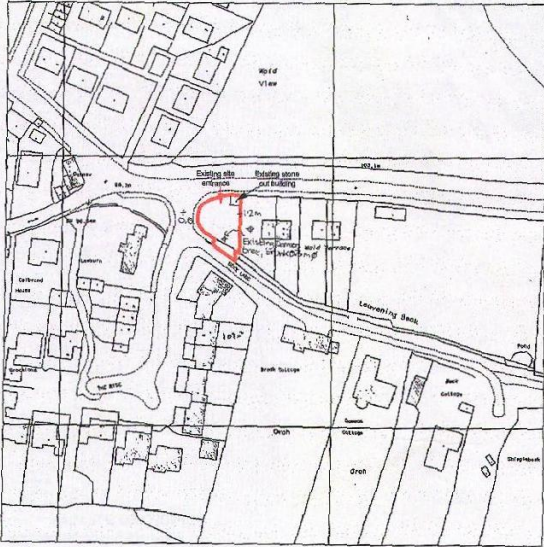

PROPOSED SITE LOCATION PLAN: showing comparable sites and development

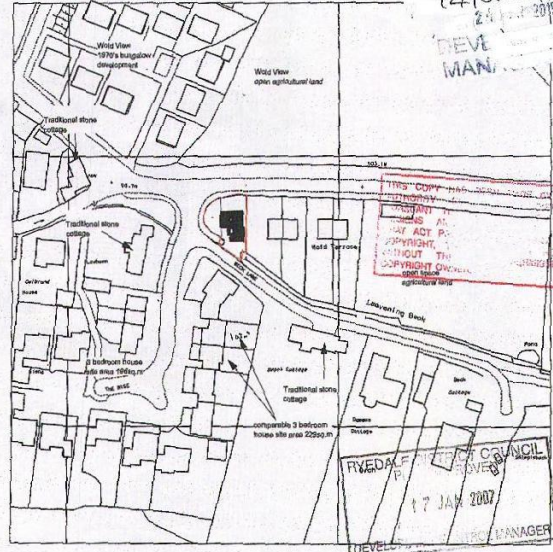

Produced 30 Sep 2006 from Ordnance Survey digital data and processing geotagged results available at this date. © Crown Copyright 2006.

Reproduction in whole or in part is prohibited without the prior permission of Ordnance Survey. Ordnance Survey and the OS symbol are registered trade marks and Siteplan® a trade mark of Ordnance Survey, the national mapping agency of Great Britain.

Part or all of this Siteplan is exempt from mapping produced at one or more of the following scales 1:1250, 1:2500, 1:10000.

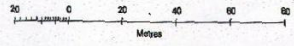

Cartic Coordinates: 476770 482857
National Grid sheet reference at centre of this Siteplan: SE7882
Supplied by: Martin Stappells Archt
Serial Number: 03001700

SCHEDULE OF SITE AREAS	
EXISTING SITE AREA (within red line boundary)	272 sq.m
SITE FOOT-PRINT OF PROPOSED BUILDING	76 sq.m
AREA OF GARDEN	196 sq.m

